

## DESCRIPTION

Designed for paging calls and general announcements, the PM-660 desk-top microphone comes with a large talk switch and a lock lever for easy and convenient operation.

## SPECIFICATIONS

Type	Moving coil microphone
Polar Pattern	Unidirectional
Rated Impedance	600 $\Omega$ , unbalanced
Rated Sensitivity	-58 dB (1 kHz, 0 dB=1 V/Pa)
Frequency Response	100 – 10,000 Hz
Output	$\phi 4.5$ ( $\phi 0.18"$ ), 2-conductor shielded cable (2.5 m (98.43")) with stereo phone plug
Talk Switch	1-push-to-talk switch, 1-locking lever, Short-off type
Remote Control	500 mA or less at 30 V DC
Finish	Microphone head : Zinc plated steel wire, gray baked paint Main unit: ABS resin, gray
Dimensions	100 (W) $\times$ 215 (H) $\times$ 150 (D) mm (3.94" $\times$ 8.46" $\times$ 5.91")
Weight	440 g (0.97 lb) (cord excluded)

※ Do not keep the lock lever placed in the locked state (ON position) for a long period of time. Doing so may cause poor conductivity in the lever switch due to deterioration with age,

## APPEARANCE

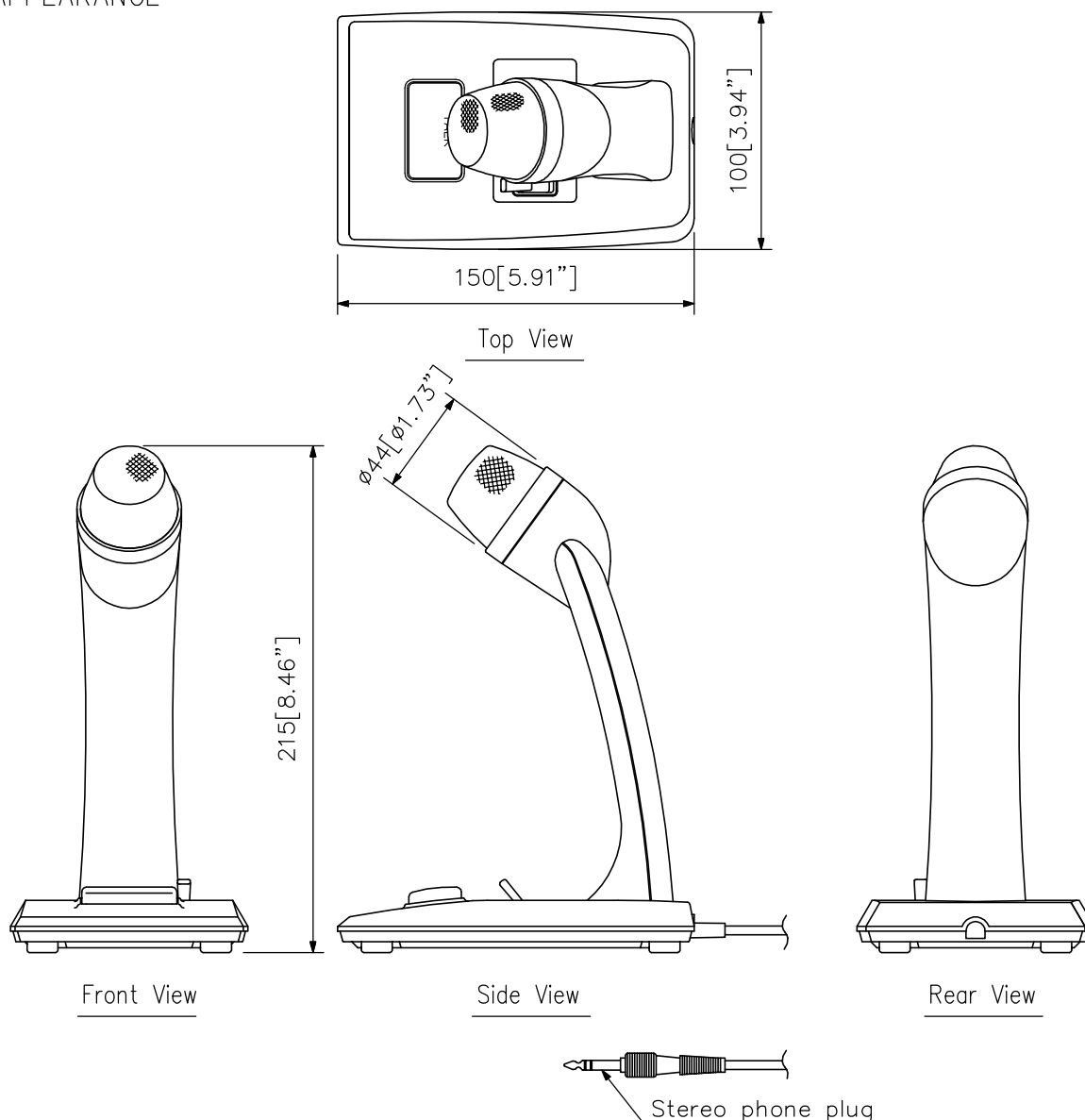

UNIT:mm SCALE:1/3